

540-1335-002-R-391

NOTICE: WHEN GOVERNMENT DRAWINGS, SPECIFICATIONS, OR OTHER DATA ARE USED FOR ANY PURPOSE OTHER THAN IN CONNECTION WITH A DEFINITELY RELATED GOVERNMENT PROCUREMENT OPERATION, THE UNITED STATES GOVERNMENT THEREBY INCURS NO RESPONSIBILITY NOR ANY OBLIGATION WHATSOEVER; AND THE FACT THAT THE GOVERNMENT MAY HAVE FORMULATED, FURNISHED, OR IN ANY WAY SUPPLIED THE SAID DRAWINGS, SPECIFICATIONS, OR OTHER DATA IS NOT TO BE REGARDED AS IMPLICATION OR OTHERWISE AS IN ANY MANNER LICENSING THE HOLDER OR ANY OTHER PERSON OR CORPORATION, OR CONVEYING ANY RIGHTS OR PERMISSION TO MANUFACTURE, USE, OR SELL ANY PATENTED INVENTION THAT MAY IN ANY WAY BE RELATED THERETO.

NOTE:  
\*FOR INFORMATION ONLY, CONTRACTOR MAY AT HIS OPTION DEVIATE FROM THESE PROCESS DETAILS

*SWE APPROVAL		REVISIONS			
SYM	PR	SYM	DESCRIPTION	DATE	APPROVAL
	PR10042-4	A <sub>2</sub>	A <sub>1</sub> -ADDED FINISH NOTE. A <sub>2</sub> -ADDED APPL. SM-D-249135, SM-D-343623, SC-DL-248775	8 OCT. 59	4242B-PC -59-A1-51. REDD PME

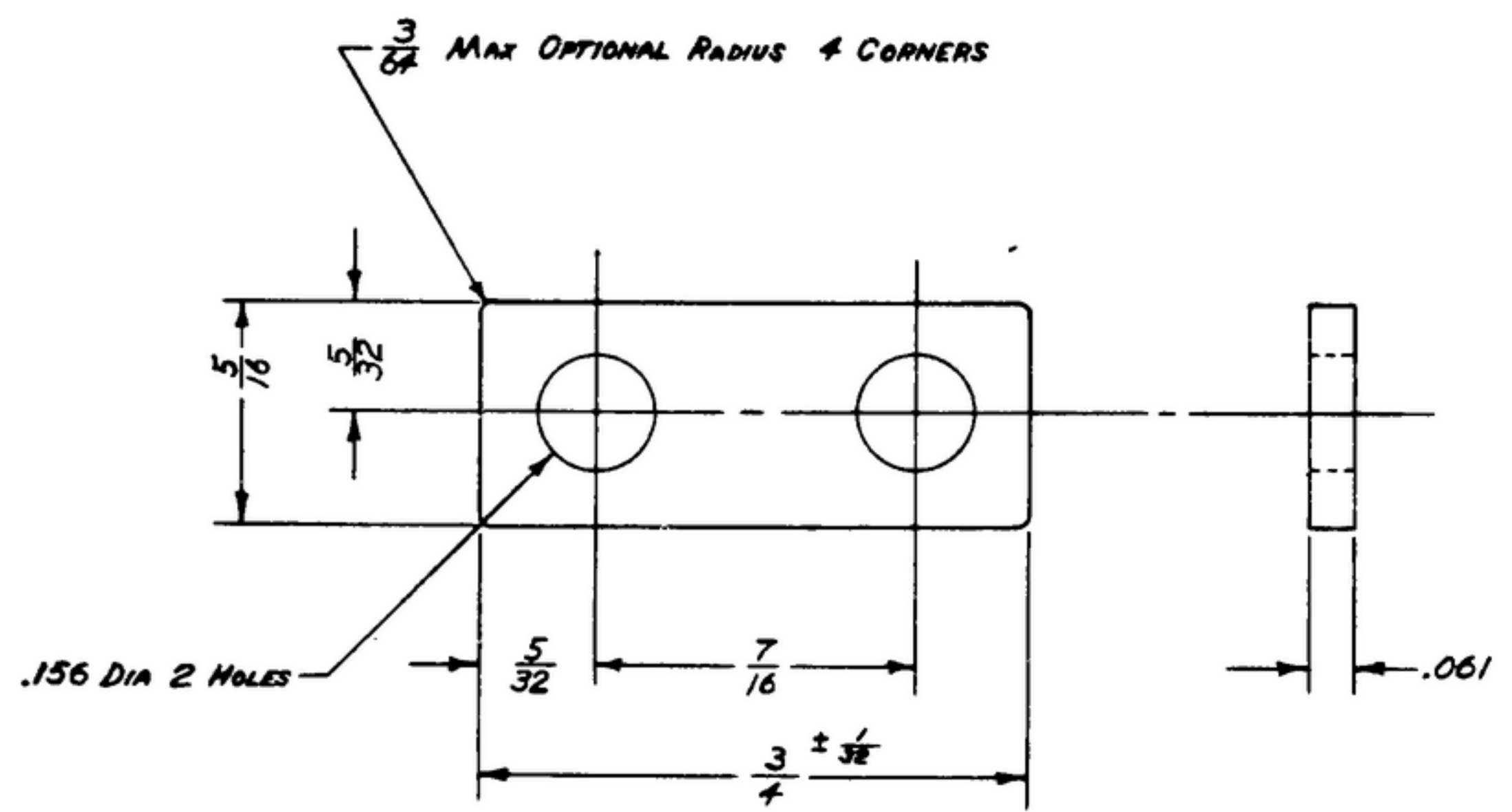

NOTES:

- A<sub>1</sub> 1.- STEEL, COLD ROLLED, COND 2, 1/2 HARD PER FED SPEC. QQ-S-636.
- 2.- FINISH: M 262 PER MIL-F-14072.
- 3.- BURR FROM BLANKING & HOLES MUST BE ON SAME SIDE OF STRIP.

QTY	PART NO.	DESCRIPTION	MATL	MATL SPEC
LIST OF MATERIAL				

A <sub>2</sub>	SM-D-343623	↑	<b>UNLESS OTHERWISE SPECIFIED</b> DIMENSIONS ARE IN INCHES TOLERANCES ON FRACTIONS DECIMALS ANGLES ± 1/64 1.005	<b>AUTHENTICATION</b> DRAWN 21852-PH-50-95 TRACED PHOTO CHECKED <i>[Signature]</i> VERIFIED RO BR APPROVED RO BR REVIEWED PME DATE 16-Nov-59 SCALE 4/1 90-447, 90585		<b>STRIP</b>  SIGNAL CORPS ENGINEERING LABORATORIES  FORT MONMOUTH NEW JERSEY  <b>SM-B-178502</b>
	SM-D-249135	SC-DL-248775				
	SM-D-178477	SC-DL-178467				
	NEXT ASSY	USED ON				
	APPLICATION					