

NOTICE: WHEN ANY DIMENSIONS, SPECIFICATIONS, OR OTHER DATA ARE SHOWN FOR ANY PART OR PARTS THEREIN IN CONNECTION WITH A SPECIFIC DRAWING, THE CONTRACTOR SHALL BE RESPONSIBLE FOR THE VERIFICATION OF THE ACCURACY OF THE DATA AND FOR THE CORRECTION OF ANY ERRORS OR OMISSIONS. THE CONTRACTOR SHALL BE RESPONSIBLE FOR THE VERIFICATION OF THE DATA AND FOR THE CORRECTION OF ANY ERRORS OR OMISSIONS. THE CONTRACTOR SHALL BE RESPONSIBLE FOR THE VERIFICATION OF THE DATA AND FOR THE CORRECTION OF ANY ERRORS OR OMISSIONS.

THIS DOCUMENT HAS BEEN CLASSIFIED BY THE AUTHORITY AND MAY BE APPROVED AND USED IN CONNECTION WITH ANY OPERATIONAL PROGRAM OR MAINTENANCE OPERATION.

*FOR INFORMATION ONLY, CONTRACTOR MAY AT HIS OPTION DEVIATE FROM THESE PROCESS DETAILS.

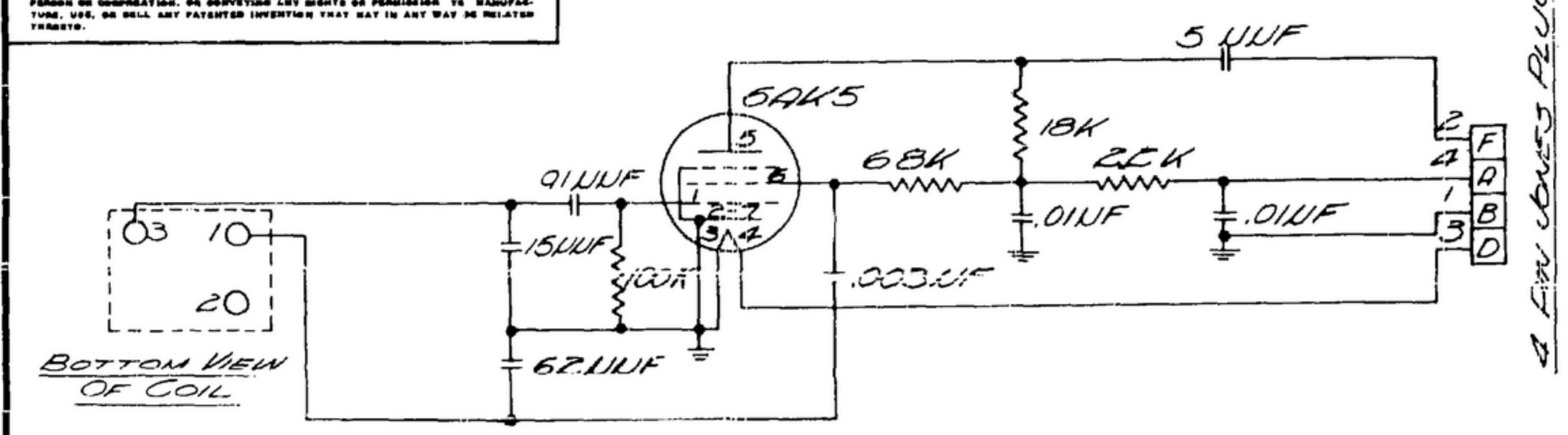

SCHEMATIC DIAGRAM

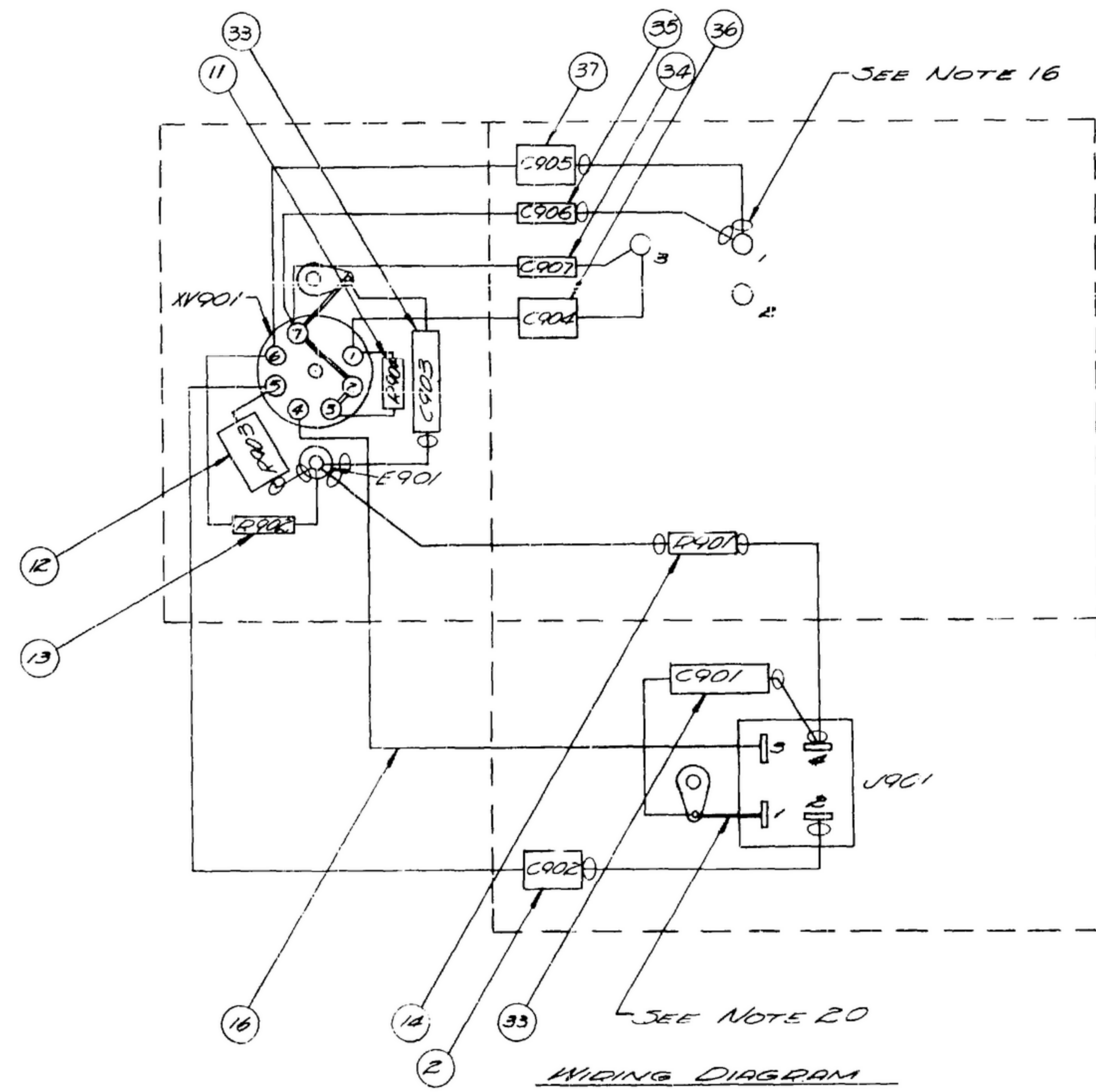
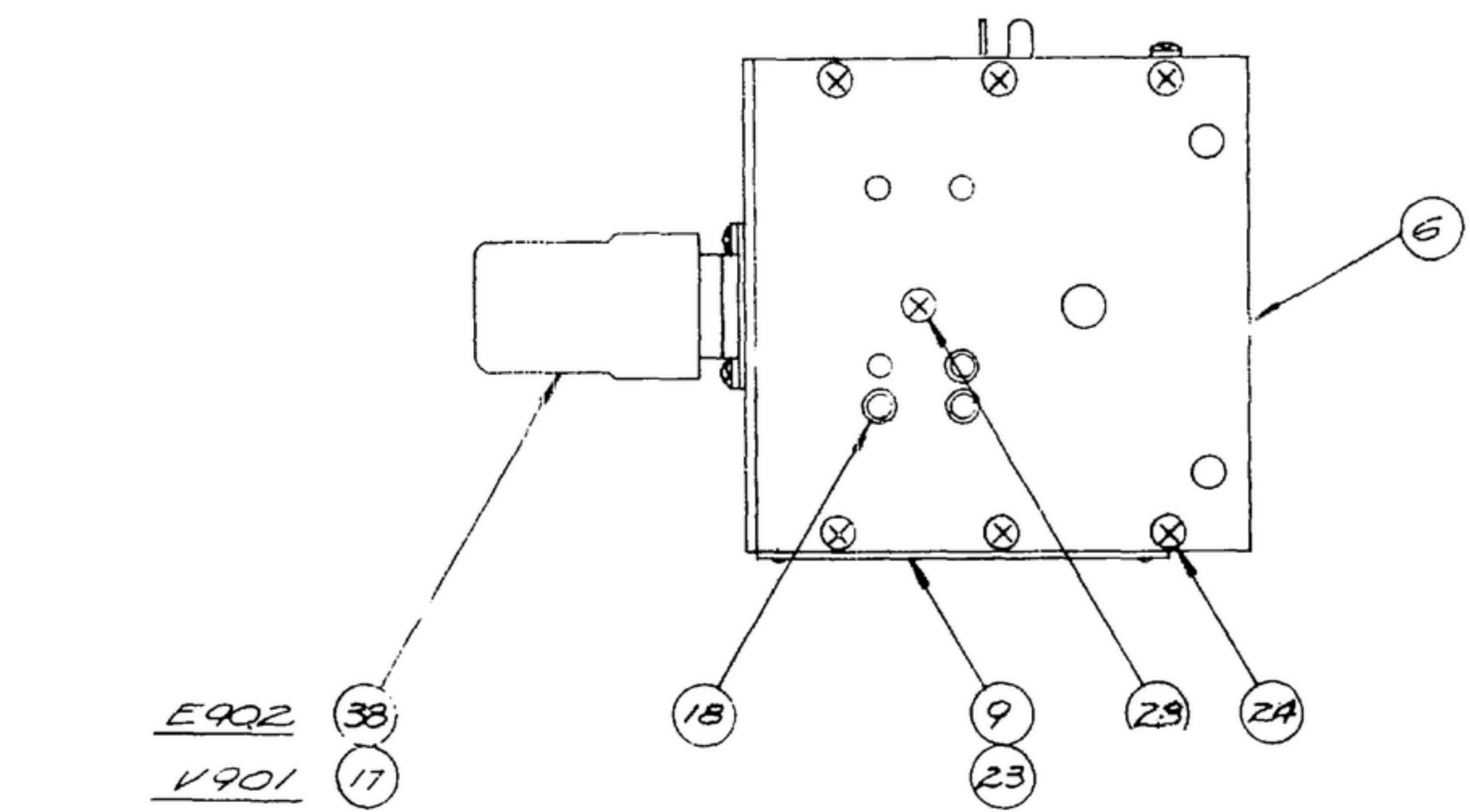
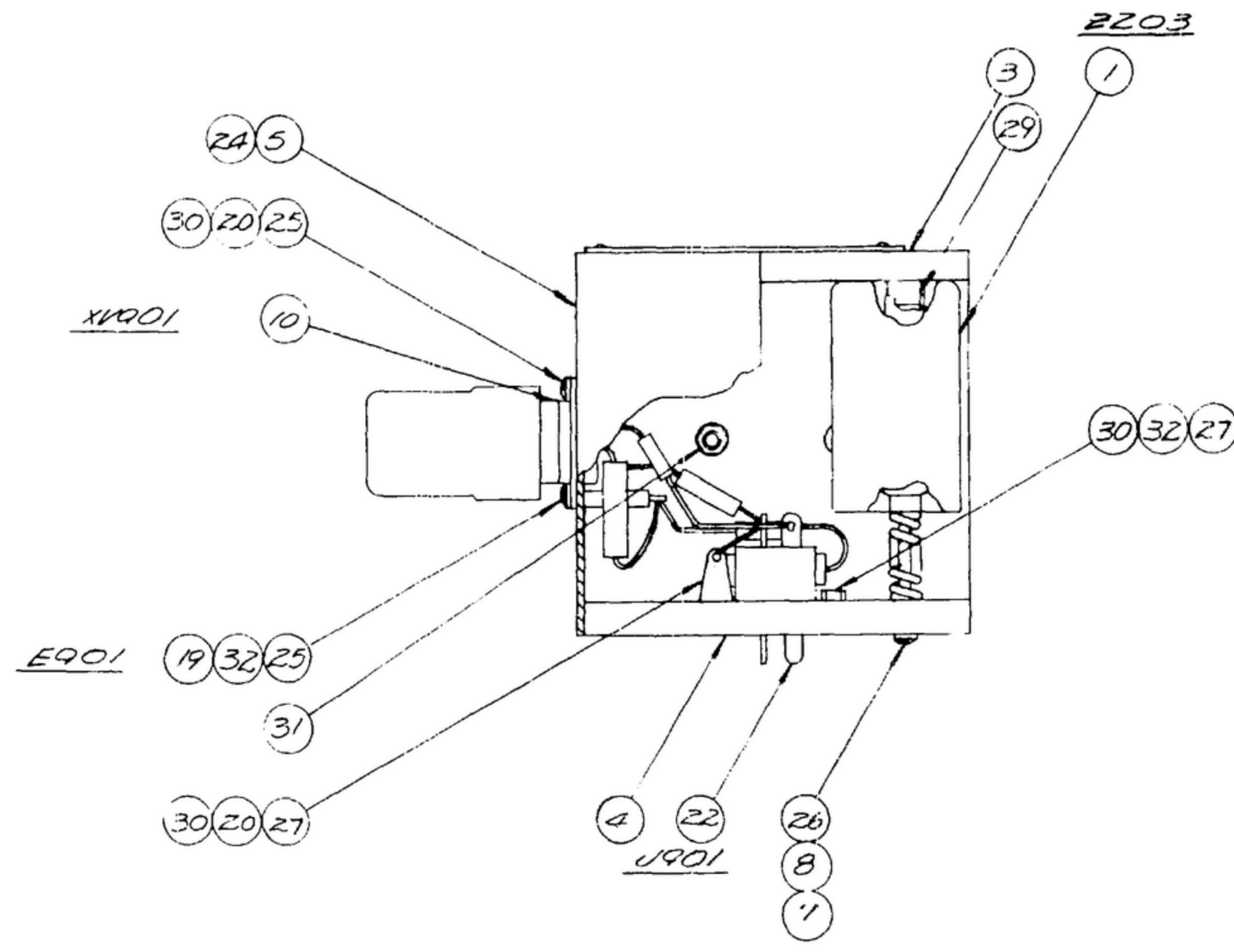

WIRING DIAGRAM

- NOTES
1. SHALL BE BORN TYPE SP1R-345(7)-2241
 2. SUPPLIED BY GENERAL ELECTRIC CORP. SCHENECTADY, NY, OR EQUAL.
 3. SUPPLIED BY SEDLECTRO COOP. NEW ROCHELLE, NY, OR EQUAL.
 4. SUPPLIED BY WHITSON INC. SCHILLER PARK, ILLINOIS, OR EQUAL.
 5. SUPPLIED BY PATTON-MACGUYER CO. PROVIDENCE, RI, OR EQUAL.
 6. SUPPLIED BY BENTLY HARRIS MFG CO. CONSHOHOCKEN, PENN, OR EQUAL.
 7. SUPPLIED BY HOWARD B JONES CO. CHICAGO, ILL, OR EQUAL.
 8. SUPPLIED BY PARKER KALON CORP. CLIFTON, N.J., OR EQUAL.
 9. SUPPLIED BY PHOENIX CO. CHICAGO, ILL, OR EQUAL. (PHILLIPS CROSS RECESSED)
 10. SUPPLIED BY BRISTOL CO. WATERBURY, CONN, OR EQUAL (6 SDRIVE)
 11. SUPPLIED BY CENTRAL SCREW CO. CHICAGO, ILL, OR EQUAL.
 12. SUPPLIED BY INLAND AUTOMATIC INC. OMAHA, NEB, OR EQUAL. (INSERT CAPTIVE)
 13. SUPPLIED BY SHAKEDROCK INC. CHICAGO, ILL, OR EQUAL.
 14. SUPPLIED BY SODAGUE ELECTRIC CO. NORTH ADAMS, MASS, OR EQUAL.
 15. SUPPLIED BY CORNELL-DUBILIER REC COOP. SOUTH PLAINFIELD, N.J., OR EQUAL.
 16. SYMBOL \oplus INDICATES TUBING (21).
 17. ALL SOLDER SHALL BE SN-50 PER QQ-5-571.
 18. COIL (1) IS SUPPLIED IN POSITION SHOWN. WHEN IN USE COIL IS PLUGGED IN SOCKETS (8) & HELD IN PLACE WITH SCREW (8).
 19. COAT ALL SOLDER CONNECTIONS WITH VARNISH TYPET PER MIL-V-773.
 20. WIRE (10) IS SHOWN BY A DOUBLE LINE
 21. SHALL BE TYPE 5 NO 22 SOFT ANNEALED 3% COATED.
 22. ALL THREADS SHALL BE DED HANDBOOK H.E.B.

QTY	UNIT	PART NO.	DESCRIPTION	MATL	FINISHED QTY	SH'T	NOTE
38	1	75102U01	SHIELD VAN-5-28				
37		-23	*125D3				
36		-22	*22R5091				
35		-21	*22R5062				
34	1	-20	*22R5015	MICA			15
33		-19	CAPACITOR 6700394	PAPER			14
32	2	-18	WASHER #1 NT SHANK				13
31	1	-17	#4-80NC-28 X 1/230 1.18 H.E.B.				12
30	3	-16	NUT #4-80NC-28 X 1/230 1.18 H.E.B.				11
29	1	-15	DIM. IN THK				10
28	1	-14	#4-80NC-28 X 1/230 1.18 H.E.B.				
27	2	-13	#4-80NC-28 X 1/230 1.18 H.E.B.				
26	1	-12	#4-80NC-28 X 1/230 1.18 H.E.B.				
25	2	-11	#4-80NC-28 X 1/230 1.18 H.E.B.				
24	10	-10	SCREW #4-80NC-28 X 1/230 1.18 H.E.B.				9
23	2	-9	DRIVE SCREW	STEEL	3/16 X 0.5800		8
22	1	-8	CONNECTOR #3M-108M				7
21	1	-7	TUBING #3M-108M				6
20	2	-6	LUG #3002				5
19	1	-5	POST #103A-1				4
18	3	-4	SOCKET #5KT-1	TEFLON			3
17	1	-3	TUBE #6AK5				2
16		-2	JAN-C-76				1
15	1	5A-D-333121	WIRE MIL-W-3861	COPPER			21
14		DC3069321					
13		DC2081683K					
12		DC2081683K					
11		DC2081683K					
10		DC2081683K					
9		SM-C-31958-9	NAME PLATE				
8		SM-B-31957	SPRING				
7		SM-B-31956	NUT				
6		SM-B-31251	PLATE				
5		SM-B-31250	TOP				
4		SM-B-31249	PLATE				
3		SM-B-31248	PLATE				
2		SM-C-2832261	CAPACITOR	MICA			
1		SM-D-289094	COIL ASSY				

UNLESS OTHERWISE SPECIFIED DIMENSIONS ARE IN INCHES TOLERANCES ON FRACTIONS DECIMALS ANGLES

COLLINS RADIO CO. 3000 BROADWAY PHOENIX, ARIZONA 85016

REVIEWED: XXX

APPROVED: [Signature]

DATE: 29 AUG 56

SCALE: _____

APPLICATION: _____

LIST OF MATERIAL

TEST OSC R-390A/URR

RF COIL Z203

2.0-4.0 MC

SIG C INSP

57292

DEPARTMENT OF THE ARMY SIGNAL CORPS ENGINEERING LABORATORIES

FORT MONMOUTH NEW JERSEY

SM-D-33312